

Schlosstalstrasse

Zürcherstrasse - Gaswerkstrasse

Betriebs- und Gestaltungskonzept

Situation 1:500

ENTWURF

LEGENDE

Bestehend

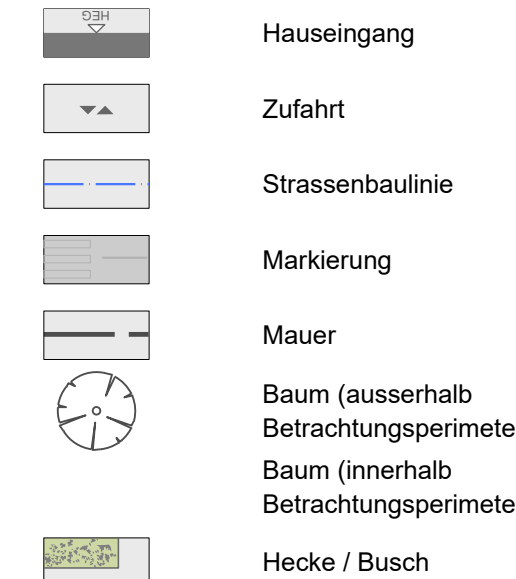

Aufzuheben

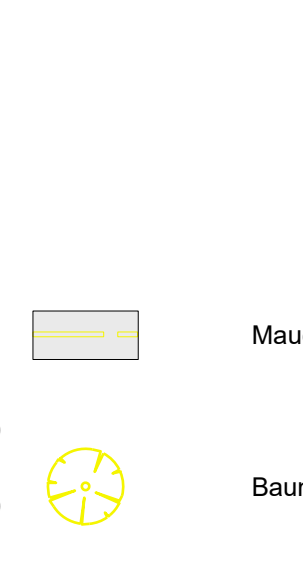

Projektiert

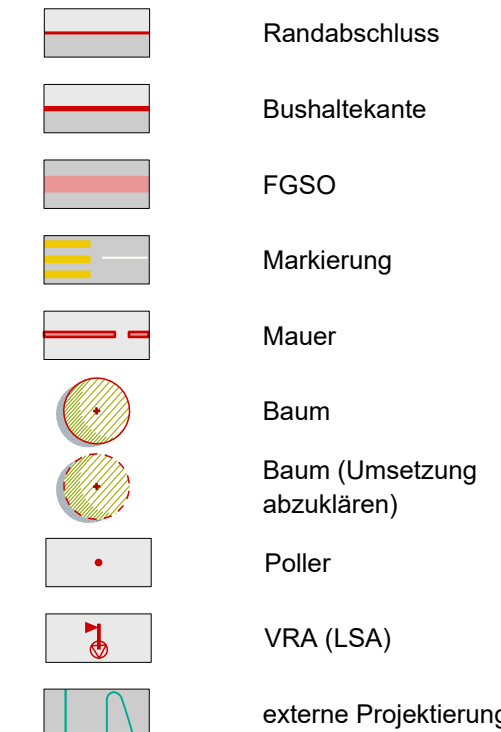

Verkehrsregime

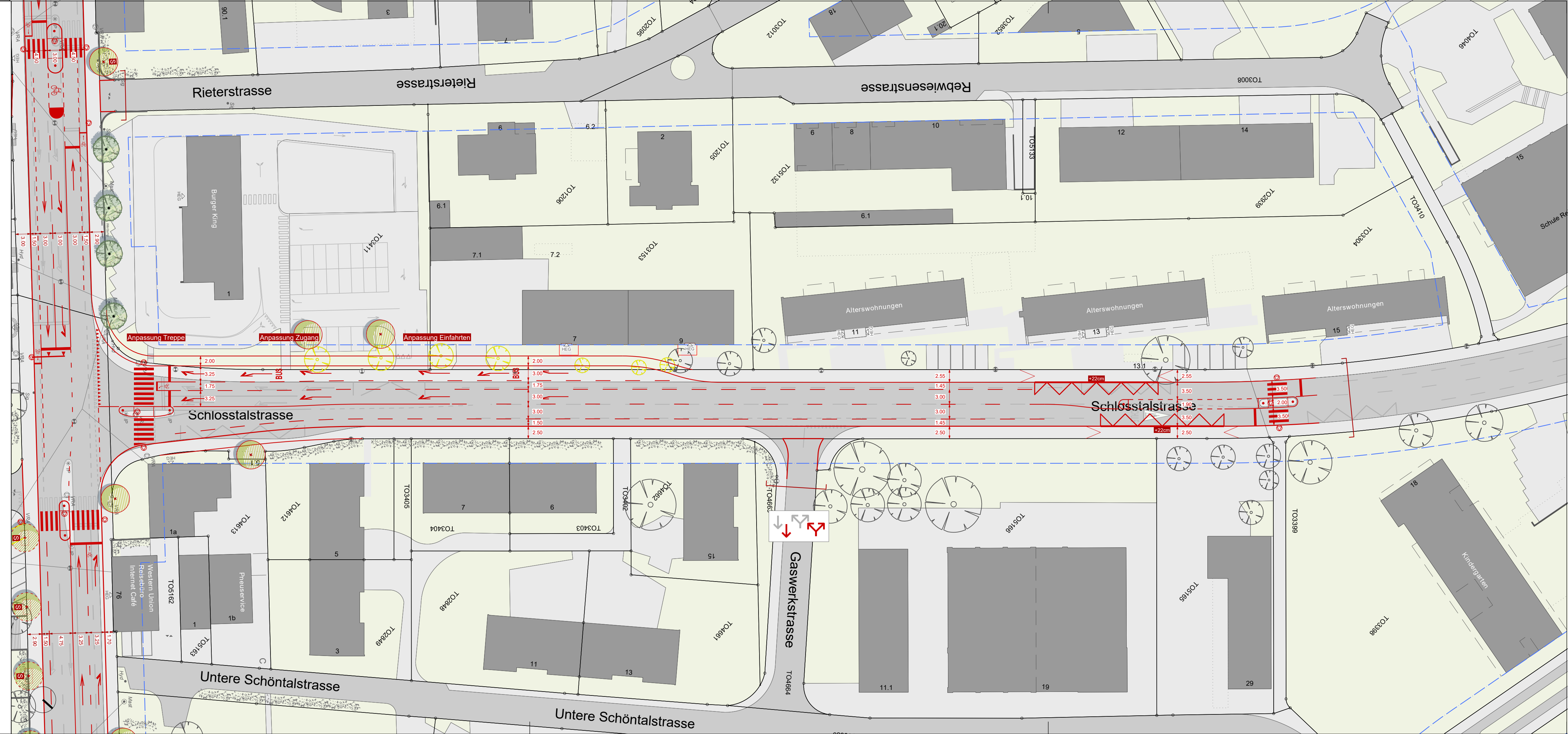

| | | | | | |
|------------|---------|--------------|---------------|------------|-----|
| Gez. | SAH | Datum | 8. Mai 2019 | Plan Nr. | 023 |
| Gepr. | | Plan Gr. | 1050 x 297 mm | Objekt Nr. | |
| Änderungen | | | | | |
| A | Datum_A | Änderungen_A | | | |
| B | | | | | |
| C | | | | | |
| D | | | | | |
| E | | | | | |